

# 2025-26 Callout Application Guide

Applications due by  
11:59pm, Sunday 3 November

To apply, fill out our [online application form](#)

Applicants will be notified of  
outcome in October



# About Pari

Pari is an artist-run initiative in Parramatta/Burramatta, operating on unceded Dharug land in New South Wales, Australia. We are for art that tells stories that need to be told, sheds new light on old thinking, or tackles new ideas altogether. We are here to support and collaborate with artists, creatives and audiences from Western Sydney and beyond. Pari is a volunteer-run, not-for-profit organisation.

For more about Pari, see [here](#).

Things we are into:

## **Paying artists**

Artists in Pari's programming are paid the below fees:

- \$400 artist fee
- \$100 artist talk participation fee
- Public program fee (if the artist facilitates a workshop, reading group, etc.)

These fees are possible with the support of the NSW Government through Create NSW and the Visual Arts, Craft and Design Strategy, an initiative of the Australian, State and Territory Governments. Further funding and income will be used to increase this fee whenever we can.

## **Making it easy for you**

We've tried to make this process as straightforward as possible. If you have questions or concerns about applying, get in touch with us on socials or email [hello@pariari.org](mailto:hello@pariari.org) and we'll get back to you as soon as we can.

## **Old work**

It doesn't matter if you've shown the work before—at Pari, it will be put together with other works to bring out new threads and conversations. The pressure on artists to constantly develop new work is unsustainable, both in terms of burnout and environmental impact. We also accept new work, or work in development, but want to be clear that old work is totally okay too.

## **Working with our space**

The gallery space at Pari is unique and we love working with its quirks. We're not a white cube - we have lots of windows and three walls. This means that we can't provide a blackout, dark or climate-controlled space.

## **Local artists**

Pari is here in large part to support artists working in the west, but not exclusively. We are also excited to bring artists and audiences from around NSW, Australia and beyond Parra. We are for connecting artists who might not usually find themselves in the same room.

## **One-off events**

We're currently working on how we support one-off events, including short turn-around exhibitions for local community groups. If you have an idea get in contact at

# About our Callout

We are currently looking for artists, creatives, organisers and curators to be part of the Pari program in 2025-26. You can apply as an individual artist to be curated into a group show, or propose a show as a curator, collective or group of artists.

Pari's 2025-26 exhibition program will continue to focus on group exhibitions, with the aim of supporting as many artists, creatives and voices as possible, and bringing them into conversation with one another. The plan is to create connections between artists with very different kinds of work, and generate intergenerational and intercommunity dialogue through each show.

Your application will be reviewed by Pari's team of co-directors. For individual applications, we cluster proposals by common themes or threads, which becomes the basis of a group show.

In 2024, Pari will present four exhibitions: three will consist of group shows drawn from individual artist applications, and one will be a proposed exhibition by a curator, collective or group of artists.

We are currently looking for proposals for the following exhibition dates in 2025-26:

- April - June 2025
- June - August 2025
- September - November 2025
- February - March 2026

In response to feedback from the previous rounds, this year's callout has the option for applicants to address the questions with an audio or video file. If there are any additional adjustments that will help you access the callout, feel free to get in touch with us at [hello@pariari.org](mailto:hello@pariari.org) and we will do our best within the capacity of our volunteer team.

As always, we hope to navigate this process with care and openness, and if you have any thoughts, questions, encouragement or concerns, please let us know.

# Exhibition Application Process

## **For artists and creatives**

You can propose a portfolio, collection of work or single artwork for consideration. This can be existing or new work/work in progress. If accepted for inclusion in the program, your work will be curated into a group show by the Pari team.

## **What we offer artists and creatives**

- \$400 artist fee (for inclusion in group exhibition)
- \$100 artist talk fee
- Public program fee (if the artist facilitates a workshop, reading group, etc.)
- Professional photo documentation
- Pari's Gallery Keepers will attend the space during gallery opening hours
- AV Equipment including TVs, projector, media players, speakers. Full list on pg.6, pending availability
- Marketing support
- Installation support
- Moral support 😊

## **What we ask of artists and creatives**

- Openness to your work being included alongside a range of other artists
- Delivery and installation of your work prior to the show (with support from Pari)
- Deinstallation and collection of your work at the end of the show

# Group/Curated Application Process

## **For curators, collectives or groups of artists**

We are accepting proposals for group shows, either organised by a curator, collective or a group of artists. Each artist's work does not need to be new, but we are looking to support an exhibition that hasn't been shown anywhere else yet. If accepted for inclusion in the program, you will lead the direction and preparation of your exhibition with the support of a Pari facilitator.

## **What we offer curators, collectives and artist groups**

- \$400 artist fee each for 5–10 artists
- \$100 artist talk fee for each artist
- \$400 curator or organiser fee
- Public program fees (if the artists, collective or curator facilitates a workshop, reading group, etc.)
- Professional photo documentation
- Pari's Gallery Keepers will attend the space during gallery opening hours
- AV Equipment including TVs, projector, media players, speakers. Full list on pg.6, pending availability
- Marketing support
- Installation support
- Moral support 😊

## **What we ask of curators, collectives and artist groups**

- Keep us in the loop throughout development of the exhibition
- Provide promotional and explanatory text
- Coordinate delivery, installation, deinstallation and collection (with support from Pari)

# How does Pari assess the applications?

All applications are reviewed independently by all Pari directors and scored out of 5. We try to keep in mind the suitability of the work for the space, our audiences and our own individual response when looking at applications.

Pari directors then come together to collectively look over the top scoring individual applications and cluster artists into group shows by common thematic. This means that sometimes artists who scored lower are able to be included into the program because they resonate with the themes. It also means that if you miss out on an exhibition spot this time, it's not necessarily because we didn't like your proposal but because it might not have fit with the themes this round.

Previous thematic and their resulting exhibitions include:

- Self-reflection, isolation, displacement — [Solo](#)
- Materiality — [Reading into Things](#)
- Fantasy, mythology, speculative futures, games — [Open World](#)
- Critique, anti-canon, resistance — [Undercurrent](#)

We will also review the top scoring group/curated applications and select the exhibition that fits best with the exhibition program.

Artists might apply a few times before getting into a Pari exhibition, so please don't be discouraged if you don't get in this time! We would love to see you apply again next year. In the meantime you can get involved by attending openings and public programs or becoming a Gallery Keeper. Gallery Keepers have the opportunity to exhibit their work in our annual show [Mixed Business](#).

We're continually developing the way we select applications and are open to shifting these processes. If you have any feedback or suggestions, please let us know.

# Other Information

## Access

The gallery is street level, with level access between the street and the gallery. Street entrance door is 1790mm wide and 2050mm tall. Please see [this document](#) for specific information regarding certain accessibility factors for this venue. If you have questions, please get in touch at [hello@pariari.org](mailto:hello@pariari.org)

## Equipment

- 4G Wi-Fi
- 3 × 55" Plasma TVs (heavy)
- 5 × 40" Kogan LEDTV
- 1 × 21" Samsung LEDTV
- 1 × 21" Kogan LEDTV
- 3 × TV Stand
- 1 × Mac Mini
- 4 × Headphones
- 1 × Projector
- 3 × Lupa Media Players
- 2 × Bluetooth Speakers
- Stereo Monitor Speakers
- PA System (no sub)
- 1 × Mixer
- 3 × Dynamic microphone
- 35 × Foldable plastic chairs
- 6 × Foldable padded chairs

When working with Pari you will have supervised access to our general construction, office and audio equipment. You'll also have access to the minds, hearts and hands of our dedicated team of co-directors and Gallery Keepers.



# The Space

Please view documentation of previous exhibitions on our website and social media to see some of the different ways the space has been used.





# Floor Plan

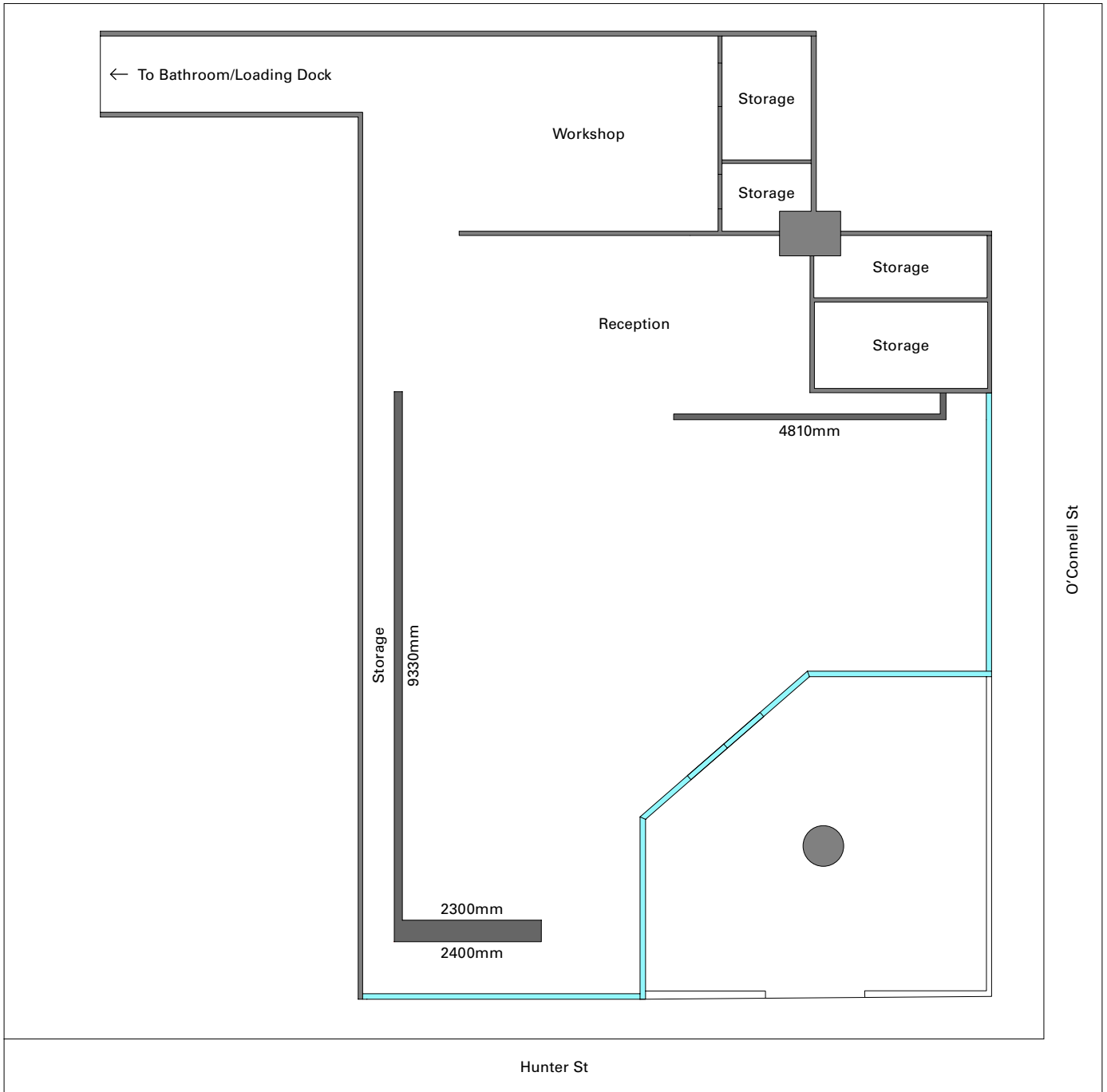

Room Height 2650mm  
Entry Height 2050mm  
Entry Width 1700mm

# Glossary

## **Artist-run initiative**

An artist-run initiative (ARI) can be a space that is run by artists and creatives – serving artists, creatives and the broader communities in which they are situated.

According to NAVA's Code of Practice, ARIs vary significantly in purpose, operations, scope and longevity. They can form around an artform, location or community, for purposes such as running a gallery, facilitating studio spaces, or publishing work. They often emerge in response to perceived limitations, gaps or opportunities within the sector or existing organisational frameworks.

## **Creatives**

Creatives are people who may not consider themselves professional/contemporary artists, but who are making creative works (arts, crafts, tech, video...) and generally doing awesome things in the world.

## **Curator**

This is a term used in the art world to describe someone who thinks up, organises and puts on exhibitions. We see the curator's role as one that is part-administrative, part-logistical, part-theoretical and part-interpersonal.

We value curating as a process of care, in particular through building relationships of care with and for artists and their work.

## **Image credits**

Front page: Rainer Ciar, *Marcel Davie and Friends* (installation view), 2020-2023.

Photography by Document Photography.

Pg.8: Installation views of *Reading into Things* at Pari, January – March 2023.

Photography by Document Photography.

Last page: Amy Claire Mills, *Isolation isn't comfortable* (installation view), 2022.

Photography by Document Photography



